

//// RotoPRECISION Inc.



MOTOVARIO



Worm Gear
Reducers



FEATURES AND BENEFITS

RotoPrecision Worm
Gear Reducers
by Motovario

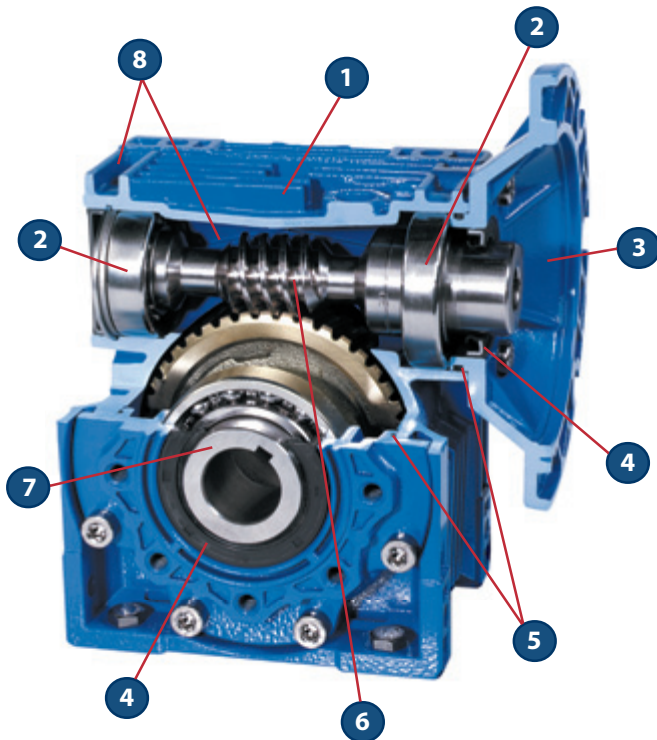

- 1 Aluminum alloy housing with patented heat sink design provides greater surface area and higher thermal capacity than traditional cast-iron housings.
- 2 Two bearings along the input shaft prevent leaks and contribute to flexibility in mounting. High quality SKF bearings increase reducer life versus worm reducers with a bushing on the input.
- 3 NEMA and IEC motor inputs are available for greater customer flexibility.
- 4 Double-lip oil seals, designed with NOK, aid the reducer's thermal capacity and extend the reducer's oil life.
- 5 Use of O-rings on the input flange and output cover prevent leaks more effectively than a paper gasket.
- 6 Hardened worm shaft gives increased durability versus forged worm shafts.
- 7 Standard hollow output bore and optional plug-in shafts provide greater flexibility in ordering and reduced inventory.
- 8 Polyester epoxy paint applied on the inside and outside of the gearcase protects against rust.
- 9 No vent plug or breather is required which results in a maintenance-free reducer that is sealed for life. This also reduces the risk of oil oxidation, contamination and allows for universal mounting.
- 10 No compression chamber ("bladder") is required which prevents leaks and contributes to mounting flexibility. This also helps reduce the risk of oil oxidation and contamination.
- 11 An automated manufacturing process from an ISO 9001 certified company assures reliable, quality gearing.
- 12 Aluminum units are prefilled with synthetic oil; cast iron units are prefilled with mineral oil.



NOMENCLATURE

TYPE	MODEL	RATIO	MOUNTING POSITION	TERMINAL BOX LOCATION	INPUT			OUTPUT
					Shaft	NEMA or IEC		
GW	030	0075	B3	1		048C00		LS
GW	075	0250	B3	1	SI			HS
GW	110	0400	B8	2			132B05	FL

GW Worm Gear Reducer



Input Flange (NMRV)

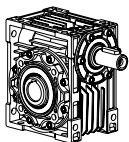

Input Shaft (NRV)

025
030
040
050
063
075
090
110
130
150

0050
(5.0:1)
0075
0100
0150
0200
0250
0300
0400
0500
0600
0800
1000

B3
B6
B7
B8
V5
V6

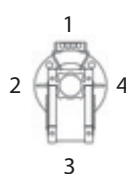

SI Inch
SM Metric
SID Inch double extension
SMD Metric double extension

048C00
(48C)
056C00
140TC0
180TC0
210TC0
250TC0
056B05
(56B5)
056B14
063B05
063B14
071B05
071B14
080B05
080B14
090B05
090B14
100B05
100B14
112B05
112B14
132B05
160B05

HS Hollow Shaft (standard)
LS Single output shaft (left)
RS Single Output shaft (right)
DS Double Output Shaft
FL Output Flange (left)
FR Output Flange (right)

*** NOTE:** Additional Accessories are available. Please see Page 5 or contact an Application Support Representative for more information.

WORM GEAR REDUCER RATINGS (AT 1750 RPM)



MODEL	RATIO	OUTPUT RPM	TORQUE		MAX. INPUT POWER		OHL - OUTPUT	
			in-lbs	Nm	hp	kW	lbs	N
025	5	350	90	10	0.48	0.36	92	409
	7.5	233	90	10	0.33	0.25	105	467
	10	175	98	11	0.28	0.21	116	516
	15	117	98	11	0.19	0.14	132	587
	20	88	97	11	0.15	0.11	146	649
	25	--	--	--	--	--	--	--
	30	58	105	12	0.12	0.09	167	742
	40	44	103	12	0.10	0.07	184	818
	50	35	91	10	0.07	0.05	198	880
60	29	80	9	0.06	0.04	210	933	

MODEL	RATIO	OUTPUT RPM	TORQUE		MAX. INPUT POWER		OHL - OUTPUT	
			in-lbs	Nm	hp	kW	lbs	N
075	7.5	233	1637	185	6.81	5.08	549	2440
	10	175	1725	195	5.45	4.07	604	2684
	15	117	1770	200	3.86	2.88	691	3071
	20	88	1858	210	3.15	2.35	759	3373
	25	70	1770	200	2.46	1.84	820	3644
	30	58	2035	230	2.48	1.85	873	3880
	40	44	1947	220	1.88	1.40	957	4253
	50	35	1858	210	1.50	1.12	1033	4591
	60	29	1770	200	1.26	0.94	1099	4884
	80	22	1681	190	0.97	0.72	1205	5356
	100	18	1593	180	0.80	0.60	1289	5729

030	5	350	159	18	1.02	0.76	113	502
	7.5	233	159	18	0.69	0.51	129	573
	10	175	159	18	0.54	0.40	142	631
	15	117	159	18	0.38	0.28	163	724
	20	88	159	18	0.30	0.22	179	796
	25	70	186	21	0.30	0.22	193	858
	30	58	177	20	0.25	0.19	205	911
	40	44	159	18	0.19	0.14	225	1000
	50	35	150	17	0.15	0.11	243	1080
60	29	142	16	0.13	0.10	259	1151	
80	22	115	13	0.09	0.07	284	1262	

090	7.5	233	2566	290	10.56	7.88	631	2804
	10	175	2743	310	8.56	6.39	694	3084
	15	117	3185	360	6.86	5.12	794	3529
	20	88	3141	355	5.19	3.87	873	3880
	25	70	3008	340	4.08	3.04	942	4187
	30	58	3628	410	4.31	3.22	1003	4458
	40	44	3185	360	2.95	2.20	1100	4889
	50	35	3008	340	2.32	1.73	1187	5276
	60	29	2831	320	1.90	1.42	1264	5618
	80	22	2522	285	1.39	1.04	1386	6160
	100	18	2389	270	1.12	0.84	1482	6587

040	5	350	301	34	1.88	1.40	221	982
	7.5	233	354	40	1.51	1.13	253	1124
	10	175	354	40	1.16	0.87	279	1240
	15	117	354	40	0.80	0.60	319	1418
	20	88	345	39	0.61	0.46	350	1556
	25	70	336	38	0.50	0.37	378	1680
	30	58	398	45	0.53	0.40	403	1791
	40	44	363	41	0.39	0.29	441	1960
	50	35	345	39	0.31	0.23	476	2116
	60	29	319	36	0.25	0.19	507	2253
	80	22	292	33	0.19	0.14	556	2471
100	18	257	29	0.15	0.11	595	2644	

110	7.5	233	4247	480	17.48	13.04	776	3449
	10	175	4601	520	14.36	10.71	853	3791
	15	117	5043	570	10.86	8.10	976	4338
	20	88	4955	560	8.10	6.04	1073	4769
	25	70	5220	590	6.90	5.15	1158	5147
	30	58	5574	630	6.53	4.87	1233	5480
	40	44	5397	610	4.81	3.59	1352	6009
	50	35	5309	600	3.93	2.93	1459	6484
	60	29	4955	560	3.19	2.38	1553	6902
	80	22	4336	490	2.25	1.68	1703	7569
	100	18	4070	460	1.79	1.34	1821	8093

050	5	350	549	62	3.43	2.56	322	1431
	7.5	233	628	71	2.64	1.97	369	1640
	10	175	637	72	2.06	1.54	406	1804
	15	117	655	74	1.48	1.10	464	2062
	20	88	646	73	1.14	0.85	510	2267
	25	70	619	70	0.90	0.67	551	2449
	30	58	743	84	0.96	0.72	586	2604
	40	44	672	76	0.70	0.52	643	2858
	50	35	646	73	0.57	0.43	694	3084
	60	29	602	68	0.47	0.35	739	3284
	80	22	575	65	0.38	0.28	810	3600
100	18	487	55	0.28	0.21	866	3849	

130	7.5	233	6636	749	27.01	20.15	1017	4520
	10	175	7255	819	22.64	16.89	1119	4973
	15	117	8140	919	17.33	12.93	1279	5684
	20	88	8052	909	13.00	9.70	1407	6253
	25	70	8229	929	10.88	8.12	1518	6747
	30	58	9202	1039	10.65	7.94	1616	7182
	40	44	9290	1049	8.27	6.17	1772	7876
	50	35	8671	979	6.42	4.79	1913	8502
	60	29	7963	899	5.12	3.82	2036	9049
	80	22	7432	839	3.79	2.83	2233	9924
	100	18	6548	739	2.84	2.12	2387	10609

063	7.5	233	1133	128	4.77	3.56	463	2058
	10	175	1150	130	3.67	2.74	510	2267
	15	117	1239	140	2.76	2.06	583	2591
	20	88	1194	135	2.05	1.53	641	2849
	25	70	1150	130	1.64	1.22	692	3076
	30	58	1416	160	1.77	1.32	736	3271
	40	44	1283	145	1.27	0.95	807	3587
	50	35	1194	135	1.01	0.75	871	3871
	60	29	1150	130	0.86	0.64	928	4124
	80	22	1079	122	0.66	0.49	1017	4520
100	18	1044	118	0.57	0.43	1088	4836	

150	7.5	233	10618	1199	43.22	32.24	1425	6333
	10	175	10972	1239	33.86	25.26	1568	6969
	15	117	11060	1249	23.27	17.36	1793	7969
	20	88	11502	1298	18.58	13.86	1971	8760
	25	70	10618	1199	14.04	10.47	2127	9453
	30	58	10618	1199	11.85	8.84	2265	10067
	40	44	13715	1548	12.21	9.11	2484	11040
	50	35	12387	1398	9.05	6.75	2680	11911
	60	29	11149	1259	7.07	5.27	2854	12684
	80	22	10175	1149	5.20	3.88	3129	13907
100	18	8848	999	3.84	2.86	3346	14871	

Conversion factors: 1 N = 0.225 lbs 1 Nm = 8.851 in-lbs 1 kW = 1.341 hp



DIMENSIONS

RotoPrecision Worm
Gear Reducers
by Motovario

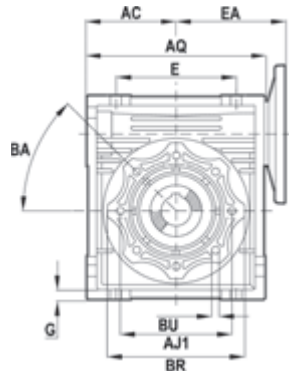

Input Flange

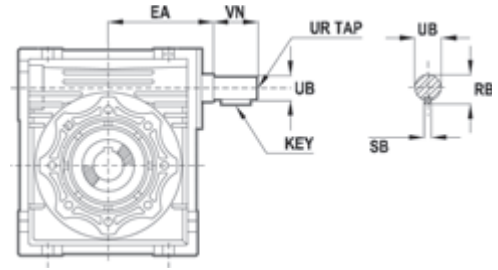

Input Shaft

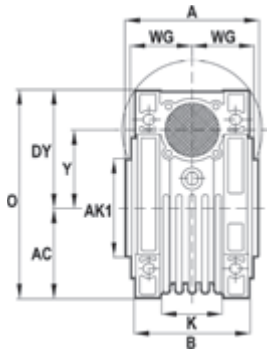

Shaft Mount

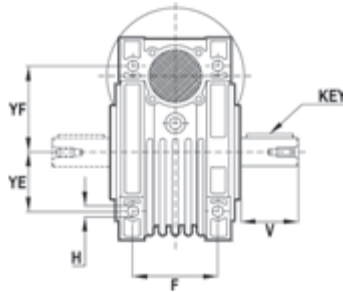

Foot Mount

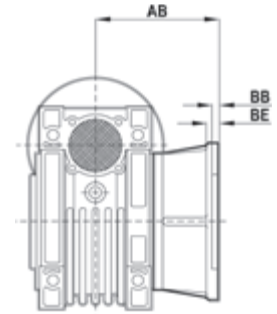

Flange Mount

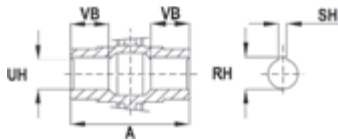

Hollow Output Bore

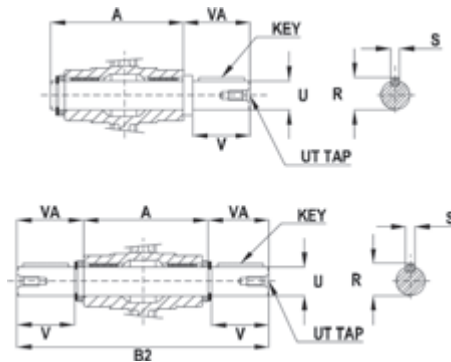

Single & Double Output Shaft

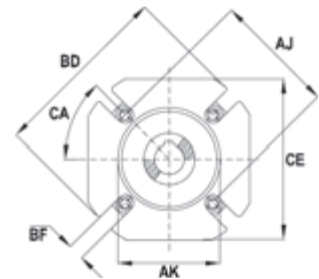

Output Flange

GEAR REDUCER DIMENSIONS - INCH / METRIC

	025		030		040		050		063		075		090		110		130		150	
	Inch	Metric	Inch	Metric	Inch	Metric	Inch	Metric	Inch	Metric	Inch	Metric	Inch	Metric	Inch	Metric	Inch	Metric	Inch	Metric
A	--	50	2.48	63	3.07	78	3.62	92	4.41	112	4.72	120	5.51	140	6.10	155	6.69	170	7.87	200
AB	--	45	2.15	54.5	2.64(3.82)	67 (97)	3.54(4.72)	90 (120)	3.23(4.41)	82(112)	4.37	111	4.37	111	5.16	131	5.51	140	6.10	155
AC	--	35	1.57	40	1.97	50	2.36	60	2.83	72	3.39	86	4.06	103	5.02	127.5	5.81	147.5	6.69	170
AJ	--	55	2.68	68	2.95(3.43)	75	3.35(3.54)	85	5.91	150	6.49	165	6.89	175	9.06	230	10.03	255	10.03	255
AJ1	--	55	2.56	65	2.95	75	3.35	85	3.74	95	4.53	115	5.12	130	6.50	165	8.46	215	8.46	215
AK	--	40H9	1.97 +0/-0.0007	50H8	2.36 +0/-0.0007	60H8	2.76 +0/-0.0007	70H8	4.53 +0/-0.0009	115H8	5.12 +0/-0.001	130H8	5.98 +0/-0.001	152H8	6.69 +0/-0.001	170H8	7.09 +0/-0.001	180H8	7.09 +0/-0.001	180H8



CONTINUED...

025		030		040		050		063		075		090		110		130		150			
Inch	Metric	Inch	Metric	Inch	Metric	Inch	Metric	Inch	Metric	Inch	Metric	Inch	Metric	Inch	Metric	Inch	Metric	Inch	Metric		
--	45 +0/-0.2	2.17 +0/-0.0018	55h8	2.36 +0/-0.0018	60h8	2.76 +0/-0.0018	70h8	3.15 +0/-0.0021	80h8	3.74 +0/-0.0021	95h8	4.33 +0/-0.0021	110h8	5.12 +0/-0.0025	130h8	7.09 +0/-0.0025	180h8	7.09 +0/-0.0025	180h8	AK1	
--	--	3.15	80	3.94	101	4.72	121	5.67	146	6.77	174	8.11	208	9.94	252.5	11.52	292.5	13.39	340	AQ	
--	42	2.20	56	2.80	71	3.35	85	4.06	103	4.41	112	5.12	130	5.67	144	6.10	155	7.28	185	B	
--	101	5.83	128	7.24	164	7.83	199	9.41	219	10.51	247	12.13	309	16.14	324	14.17	340	16.14	374	B2	
--	10°	0°	0°	45°	45°	45°	45°	45°	45°	45°	45°	45°	45°	45°	45°	45°	45°	45°	45°	45°	BA
--	2.5	0.16	4	0.16	4	0.20	5	0.24	6	0.24	6	0.24	6	0.24	6	0.28	7	0.28	7	BB	
--	75	3.15	80	4.33	110	4.92	125	7.09	180	7.87	200	8.27	210	11.02	280	12.60	320	12.60	320	BD	
--	6	0.24	6	0.28	7	0.35	9	0.39	10	0.51	13	0.51	13	0.59	15	0.59	15	0.59	15	BE	
--	6.5	0.26, 4pl	6.5	0.35, 4pl	9	0.43, 4pl	11	0.43, 4pl	11	0.55, 4pl	14	0.55, 4pl	14	0.55, 8pl	14	0.63, 8pl	16	0.63, 8pl	16	BF	
--	--	2.95	75	3.43	87	3.94	100	4.33	110	5.51	140	6.30	160	7.87	200	9.84	250	9.84	250	BR	
--	6.5	M6, 4pl	M6, 4pl	M6, 4pl	M6, 4pl	M8, 4pl	M8, 4pl	M8, 8pl	M8, 8pl	M8, 8pl	M8, 8pl	M10, 8pl	M10, 8pl	M10, 8pl	M10, 8pl	M12, 8pl	M12, 8pl	M12, 8pl	M12, 8pl	BU	
--	45°	45°	45°	45°	45°	45°	45°	45°	45°	45°	45°	45°	45°	45°	45°	22.5°	22.5°	22.5°	22.5°	CA	
--	70	2.76	70	3.74	95	4.33	110	5.60	142	6.69	170	7.87	200	10.24	260	11.42	290	11.42	290	CE	
--	48	2.24	57	2.81	71.5	3.31	84	4.02	102	4.69	119	5.32	135	6.59	167.5	7.38	187.5	9.06	230	DY	
--	45	2.13	54	2.76	70	3.15	80	3.94	100	4.72	120	5.51	140	6.69	170	7.87	200	9.45	240	E	
--	45	2.64	55	2.76	70	3.54	80	4.13	95	4.96	112.5	5.63	129.5	6.81	160	7.60	180	8.27	210	EA	
--	34	1.73	44	2.36	60	2.76	70	3.35	85	3.54	90	3.94	100	4.53	115	4.72	120	5.71	145	F	
--	5	0.22	5.5	0.26	6.5	0.28	7	0.32	8	0.39	10	0.43	11	0.57	14.5	0.61	15.5	0.71	18	G	
--	6	0.26	6.5	0.26	6.5	0.34	8.5	0.33	8.5	0.45	11.5	0.51	13	0.55	14	0.63	16	0.71	18	H	
--	22	1.26	32	1.69	43	1.93	49	2.64	67	2.83	72	2.91	74	--	--	--	--	--	--	K	
--	83	3.82	97	4.78	121.5	5.67	144	6.85	174	8.07	205	9.37	238	11.61	295	13.19	335	15.75	400	O	
--	12.5(10.2)	0.70	16	0.83	20.5	1.11	28	1.23	28	1.36	31	1.51	38	1.79	45	1.92	48.5	2.22	53.5	R	
--	--	0.42	10.2	0.55	12.5	0.70	16	0.83	21.5	0.96	27	0.96	27	1.24	31	1.36	33	1.51	38	RB	
--	12.8	0.71	16.3	0.84	20.8(21.8)	1.12	28.3(27.3)	1.24	28.3(31.3)	1.37	31.3(38.3)	1.52	38.3(41.3)	1.80	45.3	1.93	48.8	2.22	53.8	RH	
--	4(3)	0.188	5	0.188	6	0.250	8	0.250	8	0.250	8	0.313	10	0.375	12	0.375	14	0.500	14	S	
--	--	0.094	3	0.125	4	0.188	5	0.188	6	0.188	8	0.188	8	0.250	8	0.25	8	0.313	10	SB	
--	4	0.188	5	0.188	6	0.250	8	0.250	8	0.250	8(10)	0.313	10	0.375	12	0.375	14	0.500	14	SH	
--	11(9)g6	0.625 +0/-0.0005	14g6	0.750 +0/-0.0005	18h6	1.000 +0/-0.0005	25h6	1.125 +0/-0.0005	25h6	1.250 +0/-0.0005	28h6	1.375 +0/-0.0005	35h6	1.625 +0/-0.001	42h6	1.750 +0/-0.001	45h6	2.000 +0/-0.001	50h6	U	
--	11H8	0.625 +0.001/-0	14H8	0.750 +0.001/-0	18(19)H8	1.000 +0.001/-0	25(24)H8	1.125 +0.001/-0	25(28)H8	1.250 +0.001/-0	28(35)H8	1.375 +0.001/-0	35(38)H8	1.625 +0.001/-0	42H8	1.750 +0.001/-0	45H8	2.000 +0.001/-0	50H8	UH	
--	--	1/4-20	M6	1/4-20	M6	3/8-16	M10	3/8-16	M10	1/2-13	M10	1/2-13	M12	5/8-11	M16	5/8-11	M16	3/4-10	M16	UT	
--	23(25)	1.58	30	1.97	40	1.97	50	2.36	50	2.76	60	3.15	80	3.54	80	3.54	80	4.02	82	V	
--	25.5(30)	1.67	32.5	2.09	43	2.11	53.5	2.50	53.5	2.89	63.5	3.33	84.5	4.13	84.5	3.74	85	4.57	87	VA	
--	16	0.827	21	1.024	26	1.181	30	1.417	36	1.575	40	1.772	45	1.969	50	2.362	60	2.850	72.5	VB	
--	--	1.18	20	1.18	23	1.58	30	1.97	40	2.36	50	2.36	50	2.76	60	3.15	80	3.15	80	VN	
--	22.5	1.14	29	1.44	36.5	1.71	43.5	2.09	53	2.24	57	2.64	67	2.91	74	3.19	81	3.78	96	WG	
--	--	0.375 +0/-0.0005	9j6	0.500 +0/-0.0005	11j6	0.625 +0/-0.0005	14j6	0.750 +0/-0.0005	19j6	0.875 +0/-0.0005	24j6	0.875 +0/-0.0005	24j6	1.125 +0/-0.0005	28j6	1.250 +0/-0.0005	30j6	1.375 +0/-0.0005	35j6	UB	
--	--	--	--	1/4-20	--	1/4-20	M6	1/4-20	M6	1/4-20	M8	1/4-20	M8	3/8-16	M10	1/2-13	M10	1/2-13	M12	UR	
--	25	1.18	30	1.58	40	1.97	50	2.48	63	2.95	75	3.54	90	4.33	110	5.12	130	5.91	150	Y	
--	22.2	1.06	27	1.38	35	1.58	40	1.97	50	2.36	60	2.76	70	3.35	85	3.94	100	4.72	120	YE	
--	35.5	1.73	44	2.17	55	2.52	64	3.15	80	3.66	93	4.02	102	4.92	125	5.51	140	7.09	180	YF	

WEIGHT

025		030		040		050		063		075		090		110		130		150	
lbs	kgs	lbs	kgs	lbs	kgs	lbs	kgs	lbs	kgs	lbs	kgs	lbs	kgs	lbs	kgs	lbs	kgs	lbs	kgs
--	.7	3	1.2	5	2.3	8	3.5	14	6.2	20	9	29	13	77	35	106	48	185	84



MOUNTING POSITIONS

RotoPrecision Worm Gear Reducers by Motovario

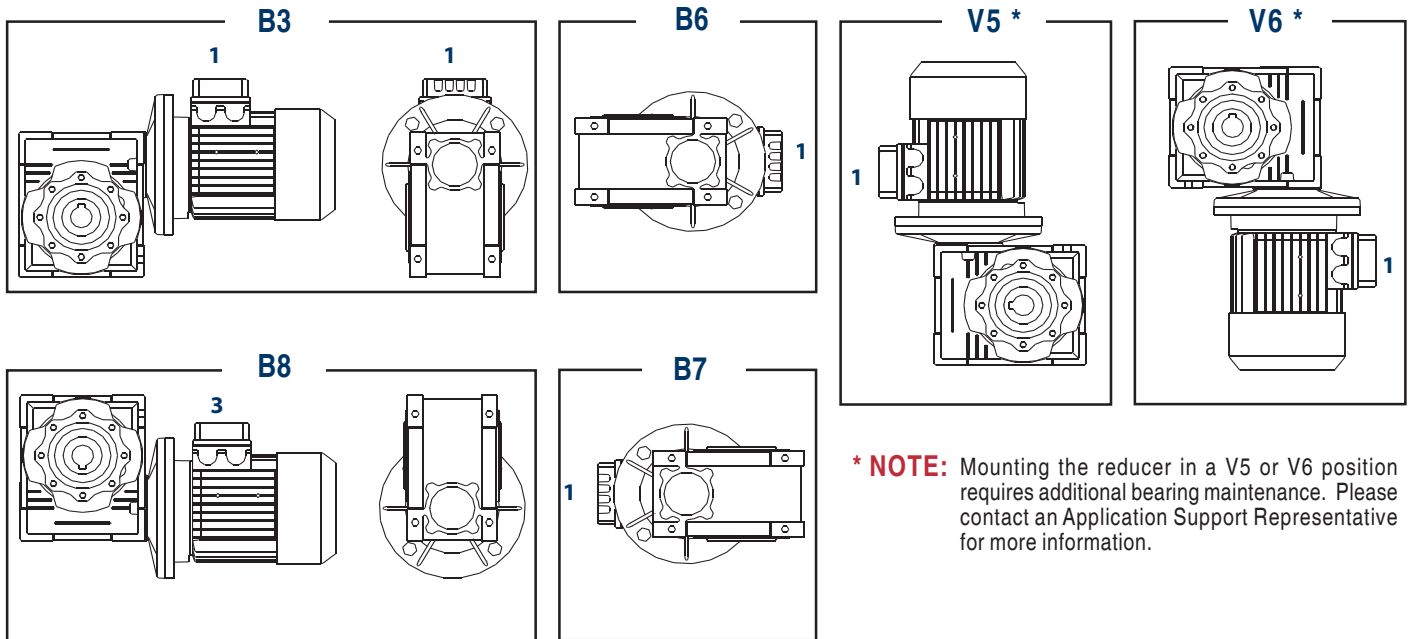

*** NOTE:** Mounting the reducer in a V5 or V6 position requires additional bearing maintenance. Please contact an Application Support Representative for more information.



ACCESSORIES

High Speed Extension Shaft *

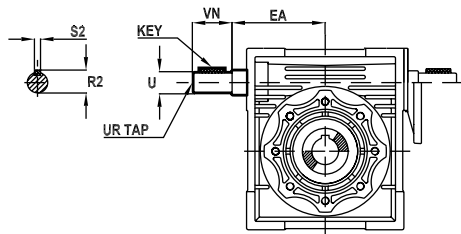

Torque Arm

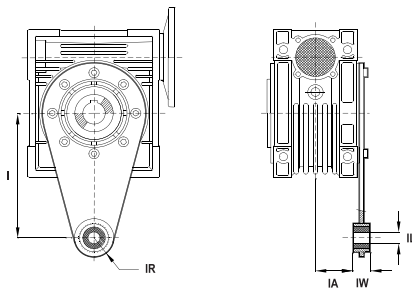

Baseplates

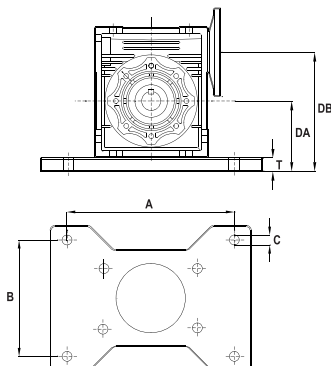

Protective Cover

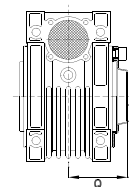

*** NOTE:** High speed extension shafts must be specified prior to gearbox construction. All other accessories listed here are available as add-ons. For more information (including dimensional data) please contact an Application Support Representative.

AVAILABLE RATIOS NEMA (INCH) / IEC (METRIC)



MODEL	FLANGE		AVAILABLE RATIOS											
	NEMA	IEC	5	7.5	10	15	20	25	30	40	50	60	80	100
025	--													
		56B14	•	•	•	•	•		•	•	•			
030	48C		•	•	•	•	•	•	•	•	•	•	•	
		63B5 & B14	•	•	•	•	•	•	•	•	•			
		56B5 & B14	•	•	•	•	•	•	•	•	•	•	•	
040	56C		•	•	•	•	•	•	•	•	•	•	•	•
		71B5 & B14	•	•	•	•	•	•	•	•				
		63B5 & B14	•	•	•	•	•	•	•	•	•	•	•	•
		56B5									•	•	•	•
050	56C		•	•	•	•	•	•	•	•	•	•	•	•
		80B5 & B14	•	•	•	•	•	•	•					
		71B5 & B14		•	•	•	•	•	•	•	•	•	•	•
		63B5								•	•	•	•	•
063	56C						•	•	•	•	•	•	•	•
	140TC			•	•	•	•	•	•	•				
		90B5 & B14		•	•	•	•	•	•					
		80B5 & B14		•	•	•	•	•	•	•	•	•		
		71B5 & B14								•	•	•	•	•
075	56C										•	•	•	•
	140TC					•	•	•	•	•				
	180TC			•	•	•								
		112B5 & B14		•	•	•								
		100B5 & B14		•	•	•								
		90B5 & B14		•	•	•	•	•	•	•	•	•	•	•
		80B5 & B14					•	•	•	•	•	•	•	•
090		71B5									•	•	•	•
	56C												•	•
	140TC							•	•	•	•	•		
	180TC			•	•	•	•	•	•	•				
		112B5 & B14		•	•	•	•	•	•	•				
		100B5 & B14		•	•	•	•	•	•	•				
		90B5 & B14		•	•	•	•	•	•	•	•	•	•	•
110		80B5 & B14								•	•	•	•	•
	140TC										•	•	•	•
	180TC							•	•	•	•	•		
	210TC			•	•	•	•	•	•	•	•	•	•	•
		132B5		•	•	•	•							
		112B5		•	•	•	•	•	•	•	•	•		
		100B5		•	•	•	•	•	•	•	•	•		
130		90B5						•	•	•	•	•	•	•
		80B5											•	•
	140TC									•	•	•	•	•
	180TC									•	•	•	•	•
	210TC			•	•	•	•	•	•	•	•	•	•	•
		132B5		•	•	•	•	•	•	•	•			
150		112B5						•	•	•	•	•	•	•
		100B5						•	•	•	•	•	•	•
		090B5											•	•
	180TC									•	•	•	•	•
	210TC					•	•	•	•	•				
	250TC			•	•	•	•							
150		160B5		•	•	•	•	•	•	•				
		132B5					•	•	•	•	•	•		
		112B5									•	•	•	•
		100B5									•	•	•	•



ALSO AVAILABLE

In-Line Helical Reducers - *The most torque within a compact envelope.*

All in-line helical reducers feature a press-fit keyless design to prevent fretting corrosion, reduce backlash and increase shock load capacities. Each housing unit is powder coated inside and out with a polyester epoxy paint for superior corrosion protection. Hardened shafts and gearing improve durability while O-rings, and not paper gaskets, ensure leak-free operation. Smaller models incorporate aluminum alloy housings for added heat resistance and reduced weight. All are available in both NEMA and IEC input configurations with ratios ranging from 1.4:1 to 354:1.

Helical-Bevel Reducers - *Excellent performance in an easily mounted package.*

The press-fit keyless design, the polyester epoxy powder coating process and the hardened shafts and gearing improve the operation and extend the useful life of these helical-bevel reducers. A specialized assembly process enables the precise positioning of the pinion gear on the motor shaft and allows for the manufacture of double and triple stage reduction units without the use of shims. Smaller models feature both compact aluminum housings to allow for the most torque possible within a compact space and standard hollow output bores to improve flexibility and reduce inventories. For heavy duty applications, larger cast-iron models are available offering up to 51,300 in-lbs of torque. All models feature squared and machined edges to facilitate "J" mounting and O-rings to ensure leak-free operation. Both NEMA and IEC configurations are available.

AC Motors - *Drive solutions.*

All AC motors feature TEFC design and corrosion-resistant aluminum housings with integral fins to improve heat dissipation and increase motor efficiency. Rotors, windings and output shafts are built to provide the maximum torque possible. A preloaded rear bearing allows for quiet performance, smooth operation and some axial movement when required. Optional AC and DC brakes may also be specified. Available in a range of NEMA and IEC configurations to fit easily into a wide variety of applications.

Mechanical Speed Variators - *Coaxial and compact performance.*

The mechanical speed variator utilizes an epicyclic gear train with oil bath lubrication for the stepless reduction of speed ranging from 1 to 5.3 times the input speed. The coaxial design, compact housing and universal mounting features allow for assembly in conjunction with a wide variety of other Motovario reducers for the further reduction of speed. All variator models feature high starting torque and operate with up to 84% efficiency at maximum speed. NEMA and IEC configurations are available.

/// RotoPRECISION Inc.

Since 1958, RotoPrecision has supplied world-class precision products to Distribution and Original Equipment Manufacturers across an ever-increasing customer network. Backed by ISO certified quality processes and outstanding Application Support, RotoPrecision is dedicated to its mission of providing "the perfect customer experience" in the markets we serve. For the Sales Office or Authorized Dealer nearest you, please contact us:

In Canada and the USA
1-888-712-5883

In Europe and the UK
(+44) 01263 732 692

On the Internet
www.rotoprecision.ca

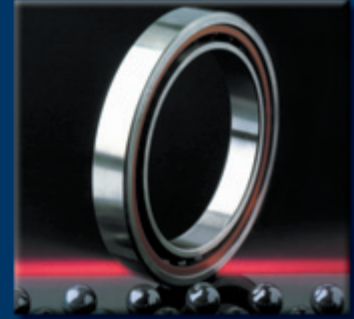

Precision Angular Contact Bearings



Precision Miniature & Instrument Bearings



Precision Zero-Backlash Reducers



Precision Servo Reducers



Precision Support
Rails & Assemblies



Precision Linear
Bearings & Bushings



Precision Case
Hardened Linear Shafting



Precision Slide Ways
& Slide Guides